

ONDO Temperature-Controlled Food Locker System 12"x16"

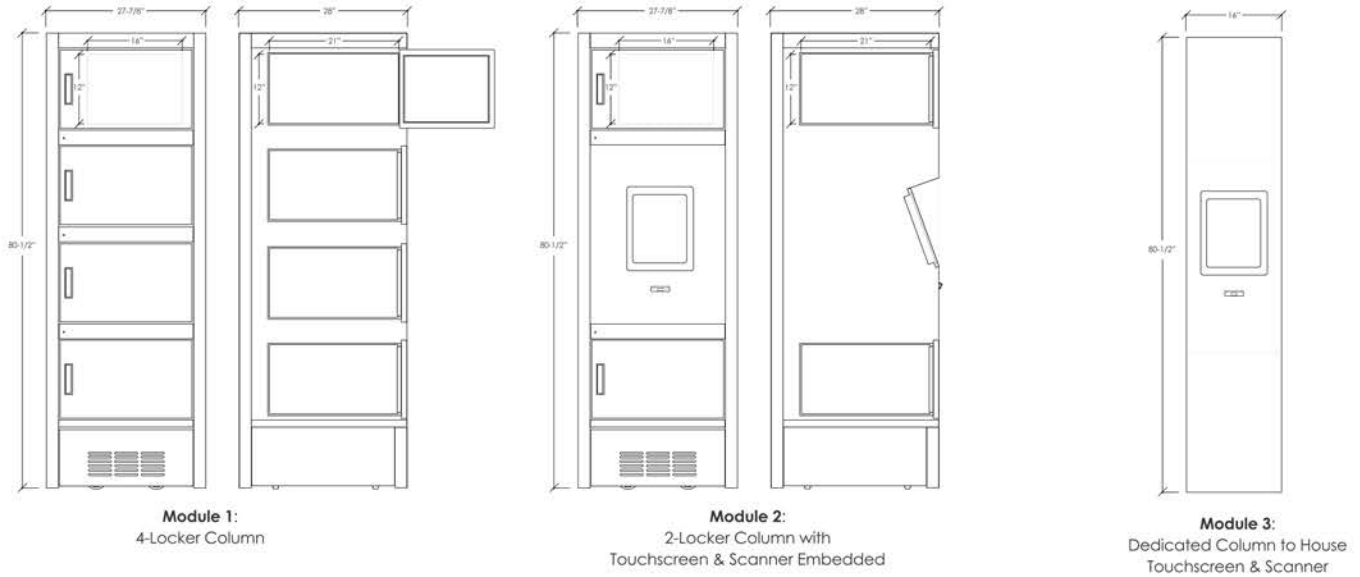

Model Nomenclature:
12x16(Q-C₁C₂...C_n) T-DUL

Variable	Q	C ₁	C ₂	...C _n	T	D	U	L
Description	Total Quantity of Lockers	Module in 1 st column	Module in 2 nd column	Remainder of the configuration	Temperature Control Option	Door Option	Unlock Option	Loading
Options		1, 2, or 3	1, 2, or 3	1, 2, or 3 for each	Convertible [CONV], Ambient Insulated [AI], Hot Only [H], Cold Only [C], Split - hot/cold [SPL], Ambient [A]	Glass [G] or Solid [S]	Spring-loaded [S] or Motorized [M]	Front [F] or Rear [R]

Example Configuration 1:
Module 1 + Module 2 + Module 1
12x16 (10-121) CONV-SSF

Example Configuration 2:
Module 3 + Module 1 + Module 1 + Module 1 + Module 3
12x16 (12-31113) CONV-SSF

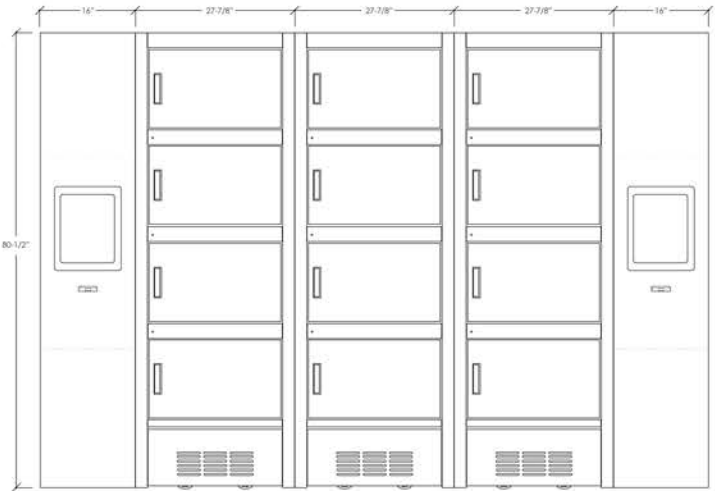
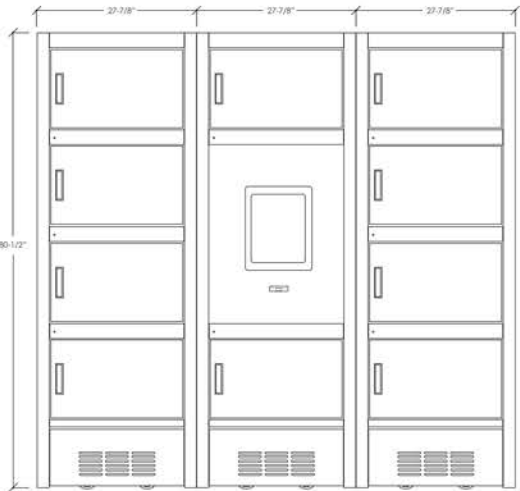

	Electrical	NEMA	Plug Qty
AI (up to 24 cubes)	115 VAC, 20 Amp, Single Phase	5-20P	1 plug per bank
AI (24 to 30 cubes)	115/208-230 VAC, 20 Amp, Single Phase	L14-20P	1 plug per bank
CONV (1 column)	115/208-230 VAC, 20 Amp, Single Phase	L14-20P	1 plug per column (module 1 or 2)
H or C (1 column)	115/208-230 VAC, 20 Amp, Single Phase	L14-20P	1 plug per column (module 1 or 2)
SPL (1 column)	115/208-230 VAC, 20 Amp, Single Phase	L14-20P	1 plug per column (module 1 or 2)

Internal Compartment Dimensions

Temp Control	Width	Height	Depth (Front Load)	Depth (Pass-thru)
AI	16-3/8"	11-7/8"	21"	23-1/4"
CONV	13-7/8"	11-7/8"	21"	23-1/4"
H	15-1/4"	11-7/8"	21"	23-1/4"
C	15"	11-7/8"	21"	23-1/4"
SPL	Consult Factory			

Overall Column Dimensions

Module	Width	Height	Depth	Weight
Module 1	27-7/8"	80-1/2"	28"	350 lbs.*
Module 2	27-7/8"	80-1/2"	28"	300 lbs.*
Module 3	16"	80-1/2"	28"	200 lbs.*

*Weights are nominal. Depending on options and exact configuration, this may vary.

Note:
Columns with temperature control (hot/cold/convertible) require individual power connections for each column. Ambient insulated and non-insulated require 1 power connection for the entire bank, up to 30 total lockers. The NEMA plugs are provided and will be coming out of the top of the column(s). Each User Interface requires an ethernet connection for internet.



The ONDO merchandiser is designed for use in stores where ambient temperatures and humidity do not exceed 80 Degrees Fahrenheit and 60% R.H. Locker system is designed for holding pre-chilled or pre-heated products within appropriate locker-temperature settings.

RPI in line with it's policy to continually improve it's products, reserves the right to change materials and specifications without notice.

